

VICINITY MAP FOR THE PROPOSED MEHAFFEY PARK REZONING

BEING A REZONING OF LAND SITUATE IN THE NORTHEAST QUARTER OF SECTION 9,
TOWNSHIP 5 NORTH, RANGE 69 WEST OF THE 6th P.M. TO THE CITY OF LOVELAND,
COUNTY OF LARIMER, STATE OF COLORADO

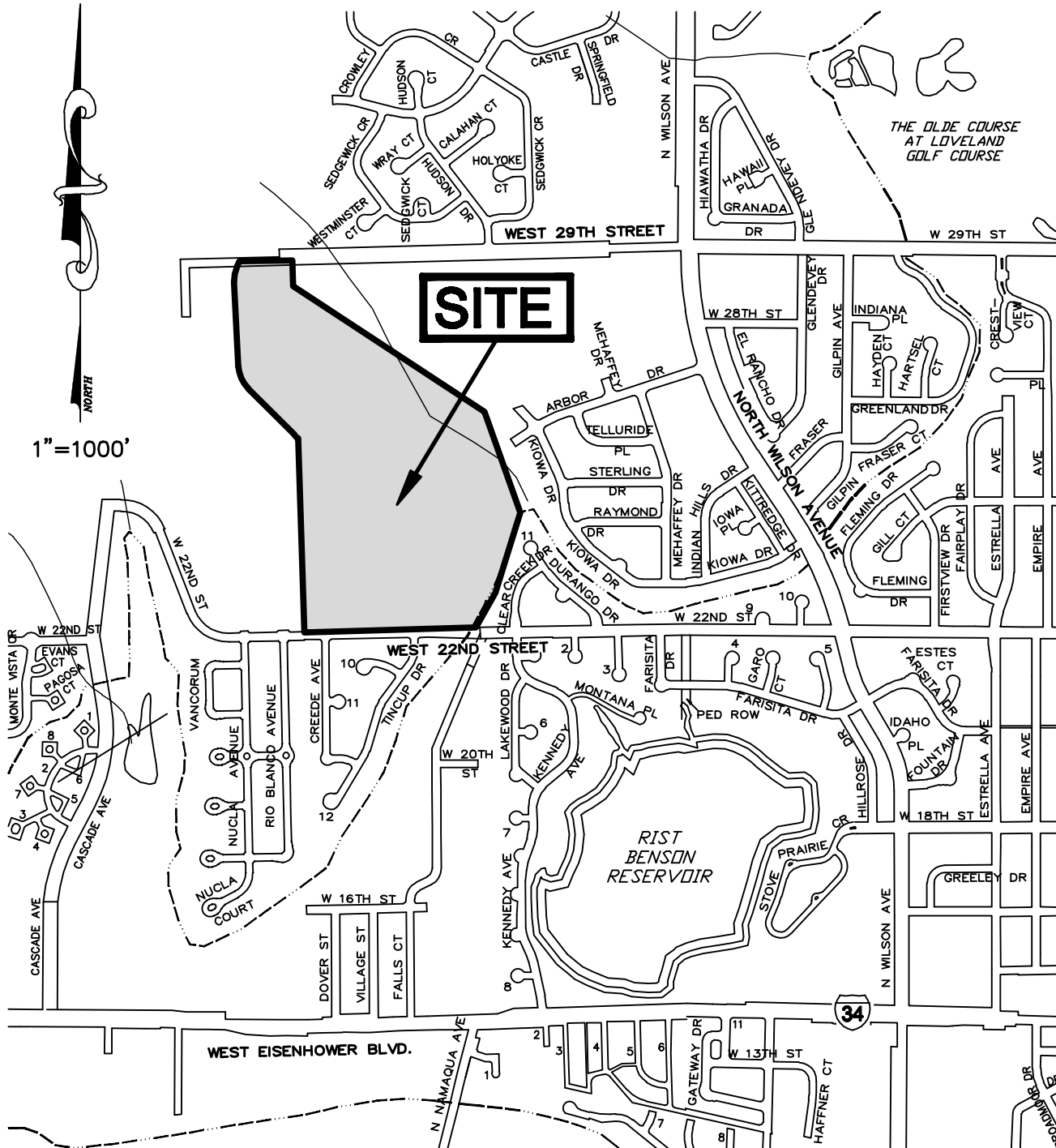

INTERMILL LAND SURVEYING, INC.

1301 North Cleveland Avenue - Loveland, Colorado 80537

P: (970) 669-0516 - F: (970) 635-9775 - E: intermill@qwestoffice.net

Project No.: P-11-7063