

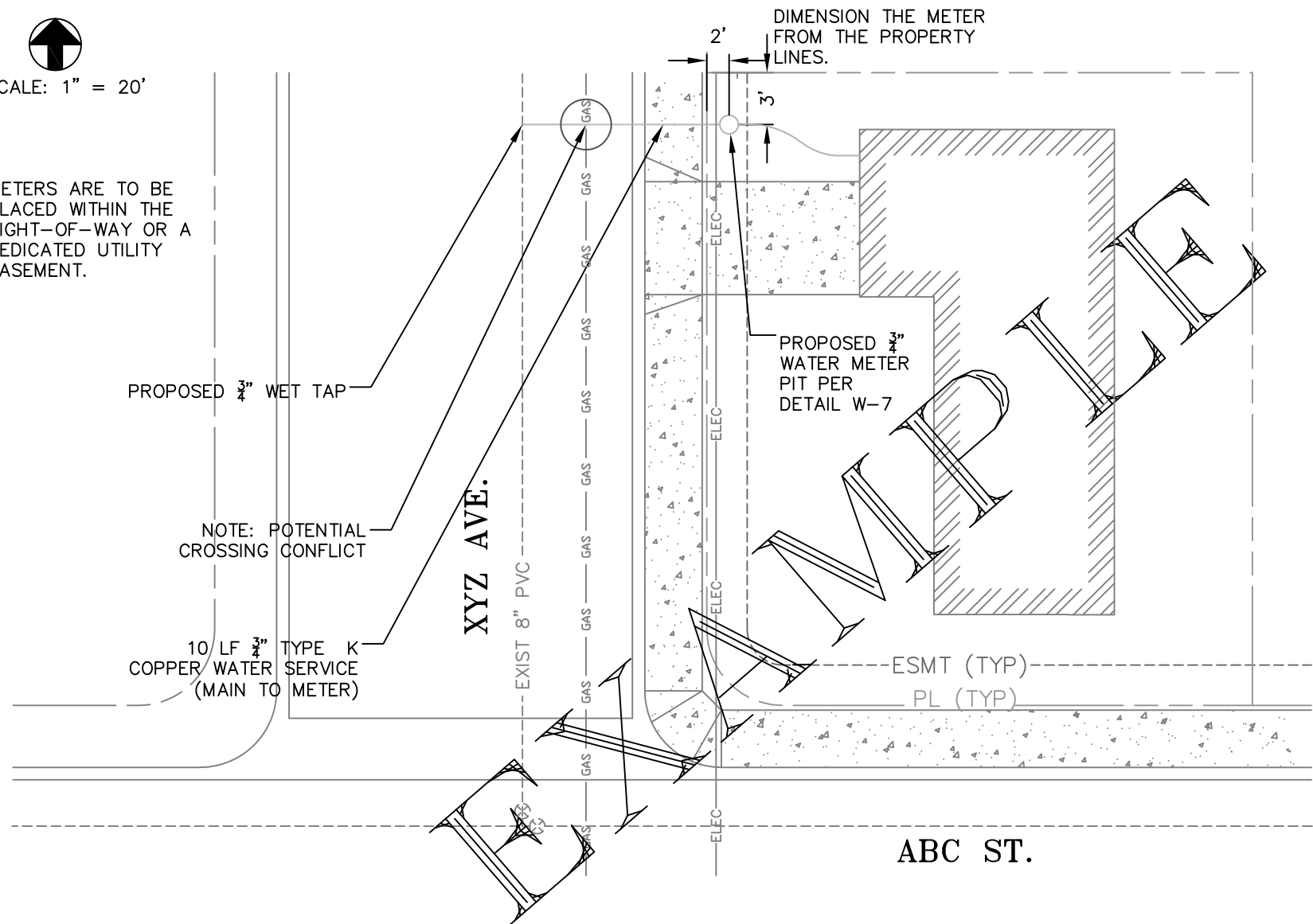

SCALE: 1" = 20'

METERS ARE TO BE PLACED WITHIN THE RIGHT-OF-WAY OR A DEDICATED UTILITY EASEMENT.



Notes:

- In addition to meeting applicable LCUASS, State or Federal Standards, all materials, workmanship and construction of Public Water and Wastewater System improvements shall meet or exceed the standards set forth in the City of Loveland Water and Wastewater Development Standards. In cases of conflict between this signed Plan and applicable standards, the most restrictive standard shall apply. In cases of conflict between the City of Loveland Water and Wastewater Development Standards and LCUASS, relating to water and/or wastewater systems, the City of Loveland Water and Wastewater Development Standards shall take precedence.
- The Contractor shall be responsible for obtaining all necessary permits from all applicable agencies. The Developer shall notify the Department of Water and Power (970-962-3000) at least 2 Working Days prior to wanting to schedule the tap for service installation.
- The Contractor shall have, onsite at all times, a signed copy of this approved Plan and copies of any applicable permits and agreements.
- If allowed by the Water and Power Department, borings may be used for the service line installation. If a boring is allowed a sleeve is required to be installed to serve as a carrier pipe for the service line. The sleeve needs to extend past the right-of-way into the site and needs to be at least two pipe sizes larger than the service line (example a 1.5" sleeve for a 3/4" service).
- A separate Street Right-of-Way Work Permit is required to be obtained prior to any construction activities occurring within City street or alley rights-of-way (includes street sidewalks), including but not limited to; construction or repair of sidewalk and/or curb and gutter, utility installation, landscaping, construction staging activities, parking striping/signing, traffic control, construction or repair for work associated with an encroachment permit, etc. Right-of-Way (ROW) Work Permit(s) must be obtained from the City's Public Works Project Engineering Division (970-962-2510) prior to any construction activities in public street or alley rights-of-way. All construction in street or alley rights-of-way (includes street sidewalks) shall comply with the Larimer County Urban Area Street Standards (LCUASS).

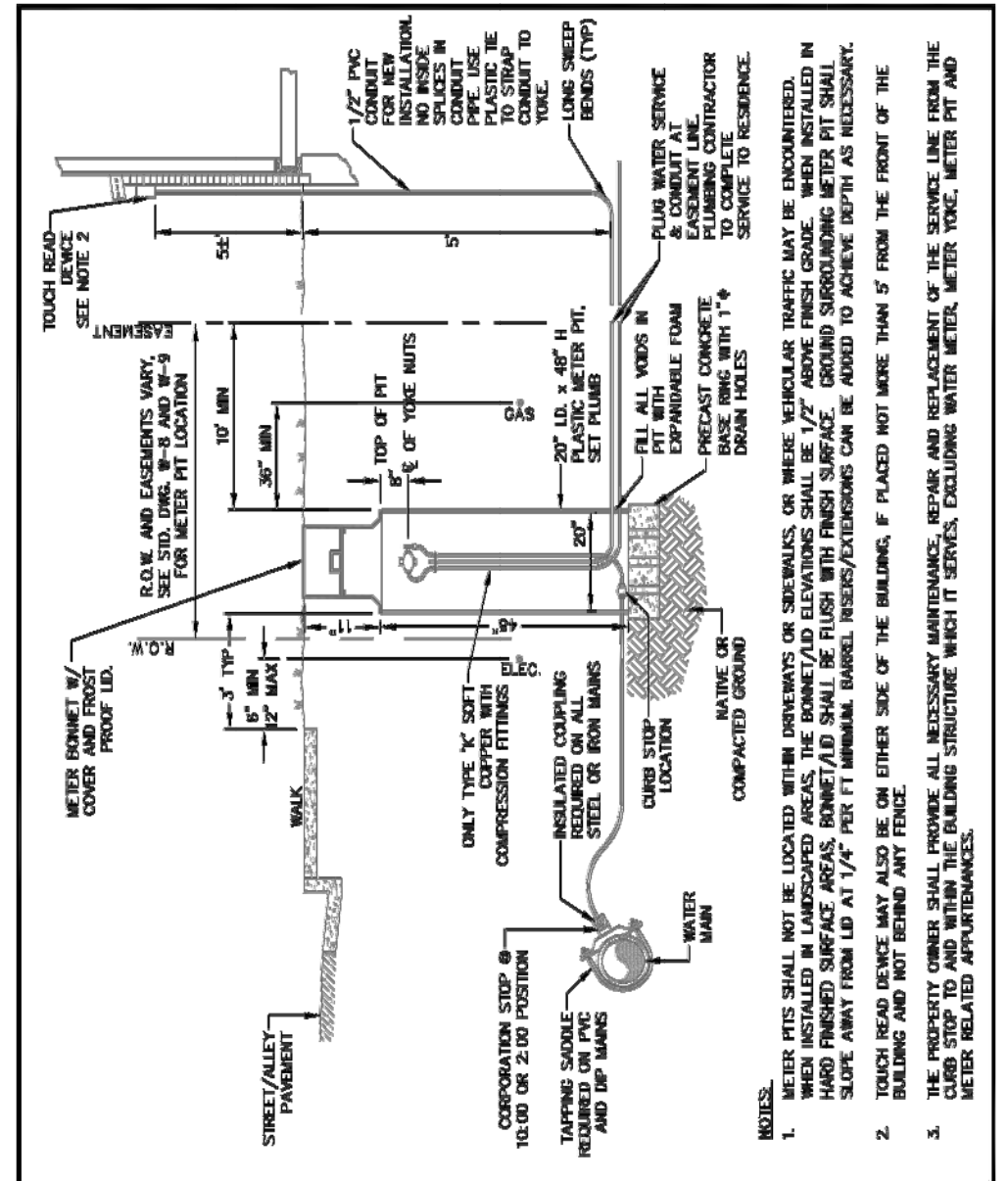

TYPICAL 3/4" & 1" SERVICE DETAIL

	CITY OF LOVELAND DEPARTMENT OF WATER AND POWER	W/WW CONSTRUCTION DRAWINGS	DATE APPROVED: 08/07	DRAWING W-7
			DATE REVISION: 2014 7TH EDITION	

- NOTES:
- METER PITS SHALL NOT BE LOCATED WITHIN DRIVEWAYS OR SIDEWALKS, OR WHERE VEHICULAR TRAFFIC MAY BE ENCOUNTERED. WHEN INSTALLED IN HARD FINISHED SURFACE AREAS, BONNET/LID SHALL BE FLUSH WITH FINISH SURFACE. GROUND SURROUNDING METER PIT SHALL SLOPE AWAY FROM LID AT 1/4" PER FT MINIMUM. BARREL INSERS/EXTENSIONS CAN BE ADDED TO ACHIEVE DEPTH AS NECESSARY.
 - TOUCH READ DEVICE MAY ALSO BE ON EITHER SIDE OF THE BUILDING, IF PLACED NOT MORE THAN 5' FROM THE FRONT OF THE BUILDING AND NOT BEHIND ANY FENCE.
 - THE PROPERTY OWNER SHALL PROVIDE ALL NECESSARY MAINTENANCE, REPAIR AND REPLACEMENT OF THE SERVICE LINE FROM THE CURB STOP TO AND WITHIN THE BUILDING STRUCTURE WHICH IT SERVES, EXCLUDING WATER METER, METER PIT AND METER RELATED APPURTENANCES.

NOTE: ADJUST DETAILS PROVIDED PER SUBMITTAL.

REVIEWED BY:
CITY OF LOVELAND – WATER/WASTEWATER ENGINEERING DIVISION

BY: _____ DATE: _____

The City of Loveland review constitutes compliance with the City's Development Standards, subject to these plans being stamped, signed, and dated by the professional engineer of record. Review by the City does not constitute approval of the plan design. Errors in the design or calculations remain the responsibility of the engineer of record. This review does not constitute review/approval of any private on-site improvements which may be shown. These plans are intended to be for City review of Public Improvements adjacent to the property.

PLAN PREPARED BY:

_____ DATE: _____

WATER SERVICE INSTALLATION ADDRESS

LOCATION LOT/BLOCK SUBDIVISION &/OR ADDITION